



XD20M

Specialized for Medical Parts



Best Choice for Medical Parts

Fixed long gun drill(2EA, Max.110mm)
High Pressure Pump(~120 bar) available



Versatile Machining Capability

Cross Drill 5ea(ER1 1x3/ER16x2)
Variety Special Tools are available



High Precision and High Rigidity

Distance from center of drill to Guide bush: 5mm

High Rigidity Cross Tool Unit



- High rigidity tool post enables hard and heavy cutting process
- Modular Type Cross Drill(5EA)
- Variety Special Tools are available
 - Polygon Tool Unit/- Thread Whirling
 - Swivel Head Unit(0~90°)

Specialized Long Gun Drill



- Fixed long gun drill 2EA (Max.110mm)
- Reinforced machining capability

User Friendly System



- Free-position OP Panel
- Crash prevent system
- Tool life control system
- Auto cut-off program
- Auto offset

Easy Maintenance

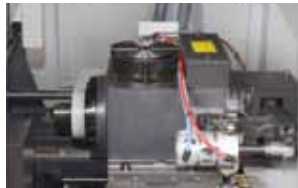

- Easy maintenance with 3 side doors (Main/Sub)
- Efficient chip discharge and smooth coolant flow enables stable continuous machining

TOOLING SYSTEM

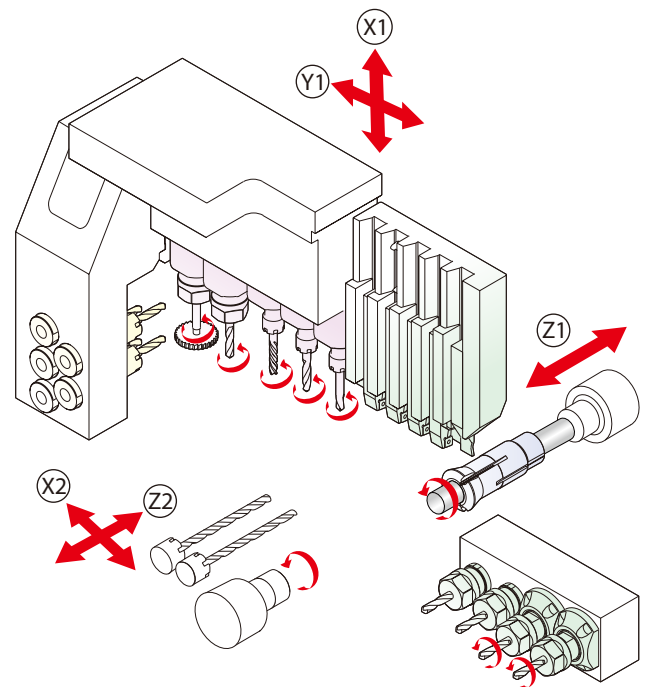

COMPLEX MACHINING

Composite Control

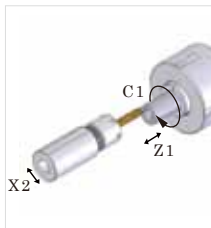

Cs Contouring Control

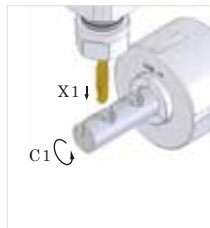

Off center drill/tap

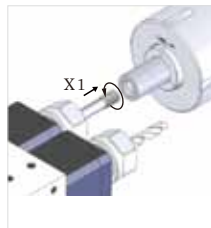

Synchronous Control

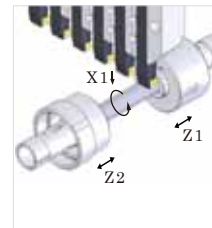

Simultaneous Machining

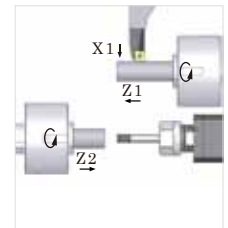

SPECIAL TOOL

SIDE CUTTER



- Max. Cutter ϕ : 50mm
- Max. rpm : 6,000
- Application(Back Tool) : Slotting

WHIRLING HEAD



- Max. Whirling ϕ : 12mm
- Max. rpm : 6,000
- Angle : Max. Left/Right 15°
- Application(Cross Tool) : Screw

3-AXIS ANGULAR TOOL
(Face/±0~90°Adjustable)

- Max. Drilling ϕ : 7mm
- Max. rpm : 6,000
- Application(Cross Tool) : Drilling/Milling/Tapping

3-AXIS LIVE TOOL
(Counter Face/Fixed)

- Max. Drilling ϕ : 7mm
- Max. rpm : 6,000
- Application(Cross Tool) : Drilling/Milling/Tapping

BACK TOOL CROSS
DRILL

- Max. Drilling ϕ : 10mm
- Max. rpm : 6,000
- Angle : Max. Left/Right 15°
- Application(Back Tool) : Drilling/Milling/Tapping

SPECIFICATION

MODEL		XD20M		
NC		HANWHA FANUC i(SIEMENS 840D)		
Max. Turning ϕ (Main)		ϕ 20		
No. of Tools	OD Tool	5EA		
	Front Tool	5EA		
	Cross Tool	5EA		
	Gun Drill	2EA(FIXED, Max.110mm)		
Motor	Main Spindle	rpm	10,000rpm	
		Power	2.2/3.7kW	
	Cross Drill	rpm	6,000rpm	
		Power	1.0kW	
Pump	Lubricant	Capacity	1.8L	
		Pump Motor	5w	
	Coolant	Capacity	170L	
		Pump Motor	0.4kW	
Weight		2,700kg		
Size(LxWxH)		2,300x1,430x1,760		
Power Consumption(Cable Size)		15kVA(Min 4 SQ)		
Air Flow Rate		120~150 Liter/Min		
SUB	No. of Tools	Back Tool	4EA(2Driven/2Fixed)	
	Motor	Sub Spindle	rpm	8,000rpm
			Power	1.5/2.2kW
	Back Tool	rpm	6,000rpm	
		Power	1.0kW	

All specifications are subject to change without notice.

STANDARD

- FULL C AXIS CONTROL ON MAIN SPINDLE
- FULL C AXIS CONTROL ON SUB SPINDLE
- ROTARY GUIDE BUSH HOLDER UNIT
- CROSS DRILL/MILLING UNIT(5EA, Modular type)
- SUB GUN DRILL(2EA, FIXED)
- MPG
- DOOR INTERLOCK
- COOLANT FLOW SENSOR
- COOLANT UNIT
- LUBRICATION UNIT
- WORK LIGHT
- SIGNAL LAMP(3COLOR)
- LAN PORT
- TOOL MONITORING FUNCTION
- TOOL BOX
- DRILL HOLDERS
- BAR FEEDER INTERFACE

OPTION

- TRANSFORMER
- PART CONVEYOR
- CHIP CONVEYOR
- CUT OFF TOOL BREAKAGE DETECTOR(S/W)
- CUT OFF TOOL BREAKAGE DETECTOR(H/W)
- TAP BREAKAGE DETECTOR
- M CODE AIR BLOW
- PIPE TYPE EJECTION UNIT
- ADDITIONAL 1 PIPE SET
- MIDDLE/HIGH PRESSURE PUMP
- SPARE M CODE KIT
- OIL MIST COLLECTOR
- OIL CHILLER
- NC WARRANTY FOR 2 YEARS
- CROSS/BACK COOLANT DRIVEN TOOL
- 4 DRIVEN BACK TOOL
- BAR FEEDER

DIMENSION

