



XD20V

Ultimate Tooling Capability with B-axis & Y2 axis



Outstanding Machining Capability
Y2 axis & B axis(Opt) available



Enhanced C/T and Productivity
Ensures better C/T by Reduction of Idle time



Strong Casting Structure
Secured both stable machining and high rigidity

Various Tooling Capability



- Y2 axis(8EA, 4Driven/4Fixed)
- Back tool cross tool(Opt)
- Rapid Traverse 40m/min
- Fixed long gun drill 2EA (Max.110mm)

B-axis Live Tool



- B axis(6EA, ER16x3EA/ER11x3EA)
- Motor Power/rpm : 1kW/6,000rpm
- Gear Hobbing & Angle adjustment

Easy to Maintenance



- Easy to maintenance with 3 side doors(Main/Sub)
- Efficient chip discharge and smooth coolant flow enables stable continuous machining

User Friendly System



- Free-position OP Panel
- Crash prevent system
- Tool life control system
- Auto cut-off program
- Auto offset

TOOLING SYSTEM

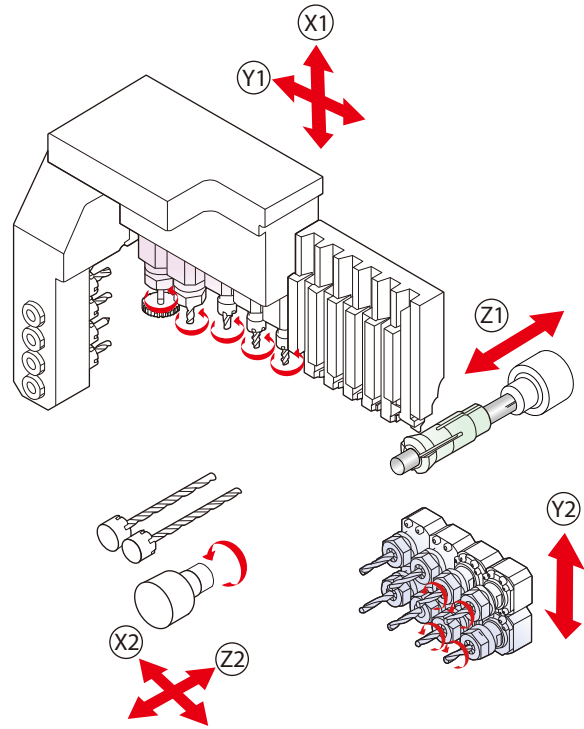

* B-axis: OPTION

COMPLEX MACHINING

Composite Control

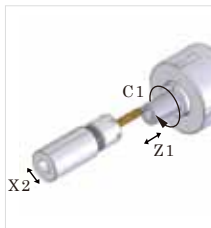

Cs Contouring Control

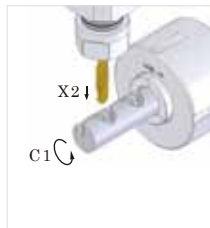

B-axis Gear Hobbing

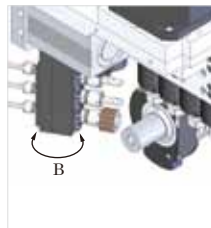

Synchronous Control

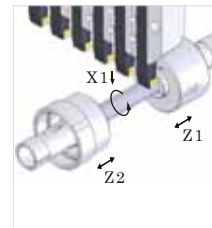

Simultaneous Machining

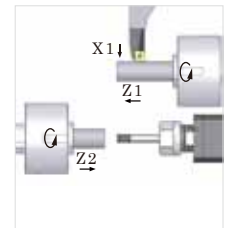

SPECIAL TOOL

SIDE CUTTER	WHIRLING HEAD	3-AXIS LIVE TOOL (Face/Fixed)	3-AXIS ANGULAR TOOL (Face/±0~90°Adjustable)	3-AXIS LIVE TOOL (Counter Face/Fixed)	BACK TOOL CROSS DRILL
					
<ul style="list-style-type: none"> Max. Cutter ϕ : 50mm Max. rpm : 6,000 Application(Back Tool) : Slotting 	<ul style="list-style-type: none"> Max. Whirling ϕ : 12mm Max. rpm : 6,000 Angle : Max. Left/Right 15° Application(Cross Tool) : Screw 	<ul style="list-style-type: none"> Max. Drilling ϕ : 7mm Max. rpm : 6,000 Application(Cross Tool) : Drilling/Milling/Tapping 	<ul style="list-style-type: none"> Max. Drilling ϕ : 7mm Max. rpm : 6,000 Application(Cross Tool) : Drilling/Milling/Tapping 	<ul style="list-style-type: none"> Max. Drilling ϕ : 7mm Max. rpm : 6,000 Application(Cross Tool) : Drilling/Milling/Tapping 	<ul style="list-style-type: none"> Max. Drilling ϕ : 10mm Max. rpm : 6,000 Angle : Max. Left/Right 15° Application(Back Tool) : Drilling/Milling/Tapping

SPECIFICATION

MODEL		XD20V	
NC		FANUC 32i-B(SIEMENS 840D)	
Max. Turning ϕ (Main)		ϕ 20	
No. of Tools	OD Tool	6EA	
	Front Tool	4EA	
	Cross Tool	5EA	
	Gun Drill	2EA(FIXED, Max.110mm)	
Motor	Main Spindle	rpm : 10,000rpm Power : 2.2/3.7kW(14.4kW)	
	Cross Drill	rpm : 6,000rpm Power : 1.0kW	
Pump	Lubricant	Capacity : 1.8L	
		Pump Motor : 5w	
	Coolant	Capacity : 170L	
		Pump Motor : 0.4kW	
Weight		2,500kg	
Size(LxWxH)		2,330x1,160x1,670	
Power Consumption(Cable Size)		15kVA(Min 4 SQ)	
Air Flow Rate		120~150 Liter/Min	
SUB	No. of Tools	Back Tool : 8EA(4Driven/4Fixed)	
	Motor	Sub Spindle	rpm : 8,000rpm Power : 1.5/2.2kW(6.1kW)
		Back Tool	rpm : 6,000rpm Power : 0.5kW

All specifications are subject to change without notice.

DIMENSION

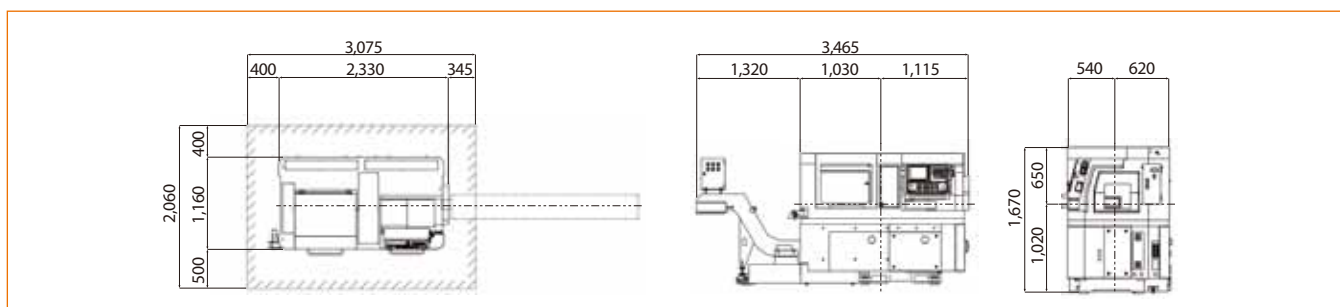

STANDARD

- FULL C AXIS CONTROL ON MAIN SPINDLE
- FULL C AXIS CONTROL ON SUB SPINDLE
- ROTARY GUIDE BUSH HOLDER
- CROSS DRILL/MILLING UNIT(5EA, Modular type)
- SUB GUN DRILL(2EA, FIXED)
- Y2 AXIS(4DRIVEN/4FIXED)
- MPG
- DOOR INTERLOCK
- COOLANT FLOW SENSOR
- COOLANT UNIT
- LUBRICATION UNIT
- WORK LIGHT
- SIGNAL LAMP(3COLOR)
- LAN PORT
- TOOL MONITORING FUNCTION
- TOOL BOX
- DRILL HOLDERS
- BAR FEEDER INTERFACE

OPTION

- TRANSFORMER
- PART CONVEYOR
- CHIP CONVEYOR
- CUT OFF TOOL BREAKAGE DETECTOR(S/W)
- TAP BREAKAGE DETECTOR
- PIPE TYPE EJECTION UNIT
- ADDITIONAL 1 PIPE SET
- MIDDLE/HIGH PRESSURE PUMP
- SPARE M CODE KIT
- OIL MIST COLLECTOR
- OIL CHILLER
- NC WARRANTY FOR 2 YEARS
- CROSS/BACK INTERNAL COOLANT DRIVEN TOOL
- B AXIS(3EA, CROSS DRILL 4EA)
- GEAR HOBBING FUNCTION
- BAR FEEDER